

Assembly Instructions for Moser 5 x 5" Bolt Pattern Hub Kits

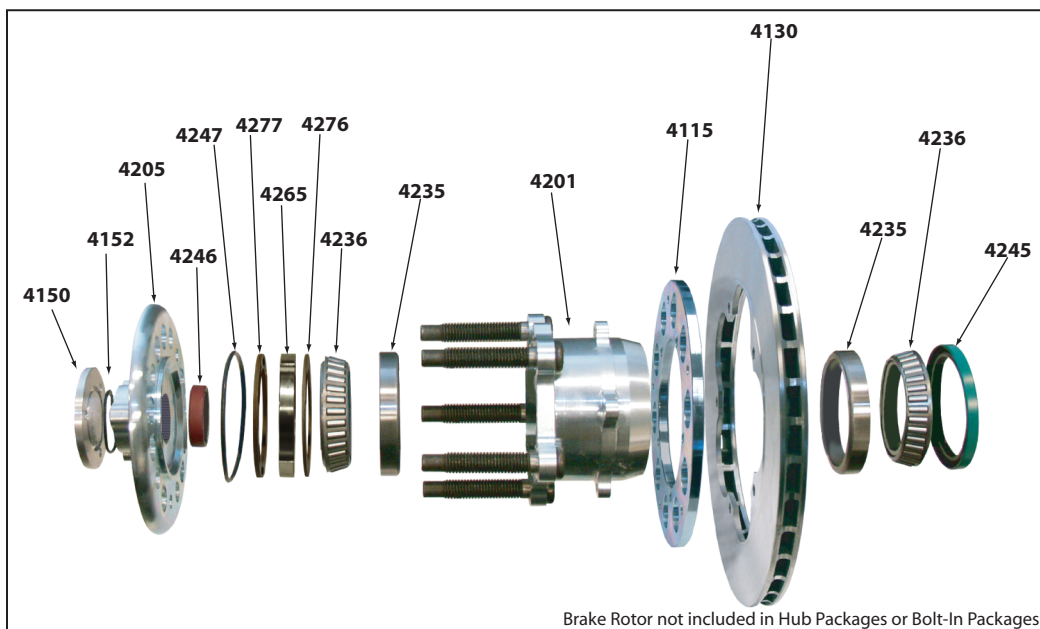

- | | |
|--|---|
| 4150. Dust Cap | 4236. Outer Hub Bearing |
| 4152. Dust Cap O-Ring | 4235. Outer Hub Race |
| 4205. Drive Flange | 4201. Hub |
| 4246. Snout Seal | 4115. Steel Rotor Adapter (5 bolt) |
| 4247. Hub O-Ring | 4130. Rotor (5 bolt) |
| 4277. Slotted Washer | 4235. Inner Hub Race |
| 4265. (rh) 4270 (lh). Snout Nut | 4236. Inner Hub Bearing |
| 4276. Flat Washer | 4245. Hub Seal |

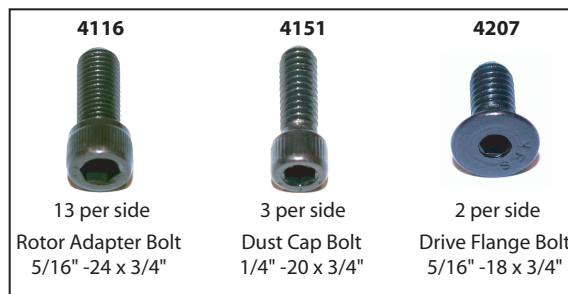

These are general assembly instructions. Actual part numbers may vary for the package that you have purchased.

Picture represents the parts included with Hub Package part # 4300P13C.

Brake rotors are sold separately.

1. Before you begin the installation, clean the drive plate and the inside of the hub.
2. Install the snout seal (4246) into snout and pack bearings with grease. Skip this step if you want the gear lube to lube the bearings.
3. Install inner hub bearing (4236) into hub (4201). Bearing races (4235) are already installed in both sides of hub.
4. Install hub seal (4245).
5. Install rotor adapter (4115) onto hub using provided bolts (4116).
6. Install rotor (4130) onto rotor adapter using provided bolts (4116). The side that the tabs are on faces outward.
7. Place hub with rotor installed onto snout.
8. Install outer hub bearing (4236).
9. Install flat washer (4275).
10. Install snout nut (4265) and tighten fully, install slotted washer and align bolt holes accordingly, then tighten button head bolts with star washers.
11. Place hub o-ring (4247) onto hub.
12. Install drive flange (4205) onto hub using the two provided bolts (4207).
13. Place dust cap o-ring (4152) onto dust cap.
14. Install dust cap (4150) onto assembly using the three provided bolts (4151).



MOSER
ENGINEERING®

The Leader In Hi-Performance Rear End Components.